

Technical Data Sheet



e.Do

CHANNEL PARTNER

EKZEN
ROBOTICS

Innovation in Automation

COMAU



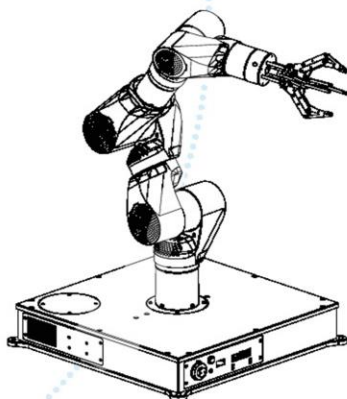
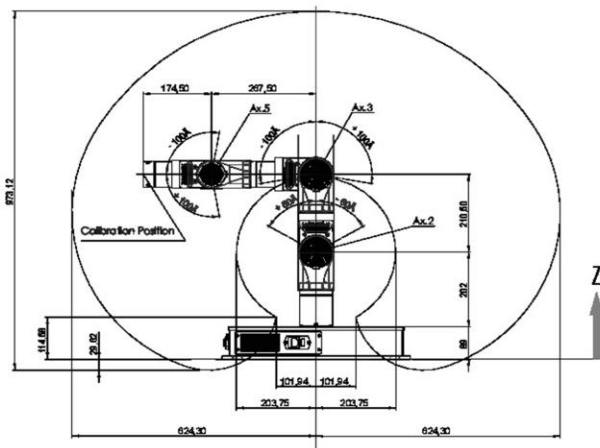

Specifications

Value

Number of axis

6

Max Payload

1Kg

Max Reach

624 mm

Stroke\Speed

Axis 1	+/- 180 deg / 40 deg/sec
Axis 2	+/- 60 deg / 40 deg/sec
Axis 3	+/- 100 deg / 40 deg/sec
Axis 4	+/- 180 deg / 30 deg/sec
Axis 5	+/- 100 deg / 30 deg/sec
Axis 6	+/- 180 deg / 30 deg/sec

Total Weight

13kg

Robot arm Weight

4,89kg

Structure Material

Ixef 1022

Power Supply

230V / 2A

Power consumption

~ 200W

Hardware

Custom PCB + Raspberry Pi 3

Communication

Ethernet / Wi-Fi / Bluetooth 4.1 / USB

Ports

1 Ethernet + 4 USB + 1 HDMI

Interface/Programming

Web application, Mobile application.

e.Do is made up with standard motor joint modules.

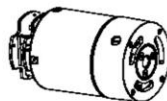
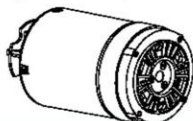

Specifications

Joint Type 1 (Big)*

Joint Type 2 (Small)**

Maximum Static Torque

15 Nm

2,5 Nm

Length

117mm

90mm

Diameter

85mm

70mm

Weight

640g

340g

* For Axes 1-2-3

** For Axes 4-5-6